

HW - 2 (L) / HW - 2 WIRE ROPE HOISTS

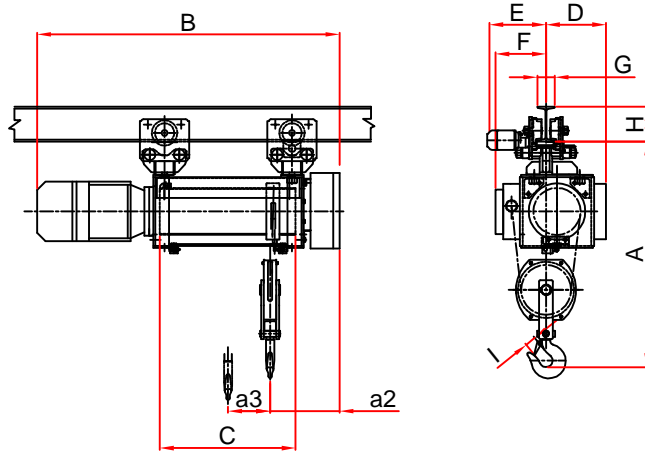

Type		HW2 (L)								HW2							
		H1	H3	H5	H7	H1	H3	H5	H7	H2	H4	H6	H9	H2	H4	H6	H9
Drum Length (C)	mm	583	832	1232	1631	583	832	1232	1631	699	1032	1432	2031	699	1032	1432	2031
SWL Class - II	Tonnes	1.5				3				3				6			
SWL Class - IV	Tonnes	1.25				2.5				2.5				5			
Lift	M	12	20	35	50	6	10	18	25	12	20	35	50	6	10	18	25
No. Of Falls																	
Wire Rope Dia.	mm	8				8				10				10			
Hoisting Speed	M/Min.	5.9				2.95				8.2				4.1			
Hoisting Motor Kw.	Kw	2.2				2.2				5.5				5.5			
Travelling Speed	M/Min.	17				17				17				17			
Travelling Motor Kw.	Kw	0.18 KW				0.37 KW				0.37 KW				0.55 KW			
Trolley Wheel (Dia./Qty.)	mm /Nos.	140 (4)				140 (4)				140 (4)				140 (4)			
Dimn. A (Head Room)	mm	1230				1180				1280				1240			
Dimn. (B) (Note-1)	mm	1375	1625	2025	2425	1376	1625	2025	2424	1597	1882	2262	2881	1597	1882	2262	2881
Dimn. D	mm	210				243				210				243			
Dimn. E (Note-3) Min.	mm	600				600				600				600			
Dimn. F	mm	321				205				321				205			
Dimn. G (Flange Width)	mm	90 - 180				125 - 210				90 - 180				125 - 210			
Dimn. H (Beam Hight)	mm	175				250				Note-4 175				250			
Dimn. I	mm	37				42				42				52			
Dimn. a2	mm	370				406				370				406			
Dimn. a3	mm	160	280	480	680	95	175	310	440	215	380	580	780	130	245	375	815
Approx. Weight	Hoist	220	250	305	340	245	270	320	365	235	270	320	365	255	295	340	385
	Trolley	120	120	120	120	120	120	120	120	150	150	150	150	150	150	150	150
	Total	340	370	425	460	365	390	440	485	385	420	470	515	405	445	490	535

NOTES:

Data Tolerance ±10% .

- 1) 1:3 CREEP SPEED CAN BE GIVEN AT EXTRA COST & DIMENSIO 'B' WILL INCREASE BY 165 MM
- 2) 13,26 MPM TROLLIES ALSO CAN BE SUPPLIED (SINGLE REDUCTION GEAR BOX)
- 3) 8.5, 4.25, 2.8, 2.1 MPM TROLLIES ALSO CAN BE SUPPLIED (DOUBLEE REDUCTION GEAR BOX) AT EXTRA COST, DIMENSION 'E' WILL INCREASE IN 100MM.